

# ST. MELS CHURCH - PARISH HALL

4748 PENNSYLVANIA AVENUE  
FAIR OAKS, CALIFORNIA

1478 STONE POINT DRIVE  
SUITE 350  
ROSEVILLE CA 95661  
T | 916 782 7200  
F | 916 773 3037  
BORGESARCH.COM

ARCHITECTURE  
PLANNING  
INTERIORS

ARCHITECTURAL GROUP  
**Borges**

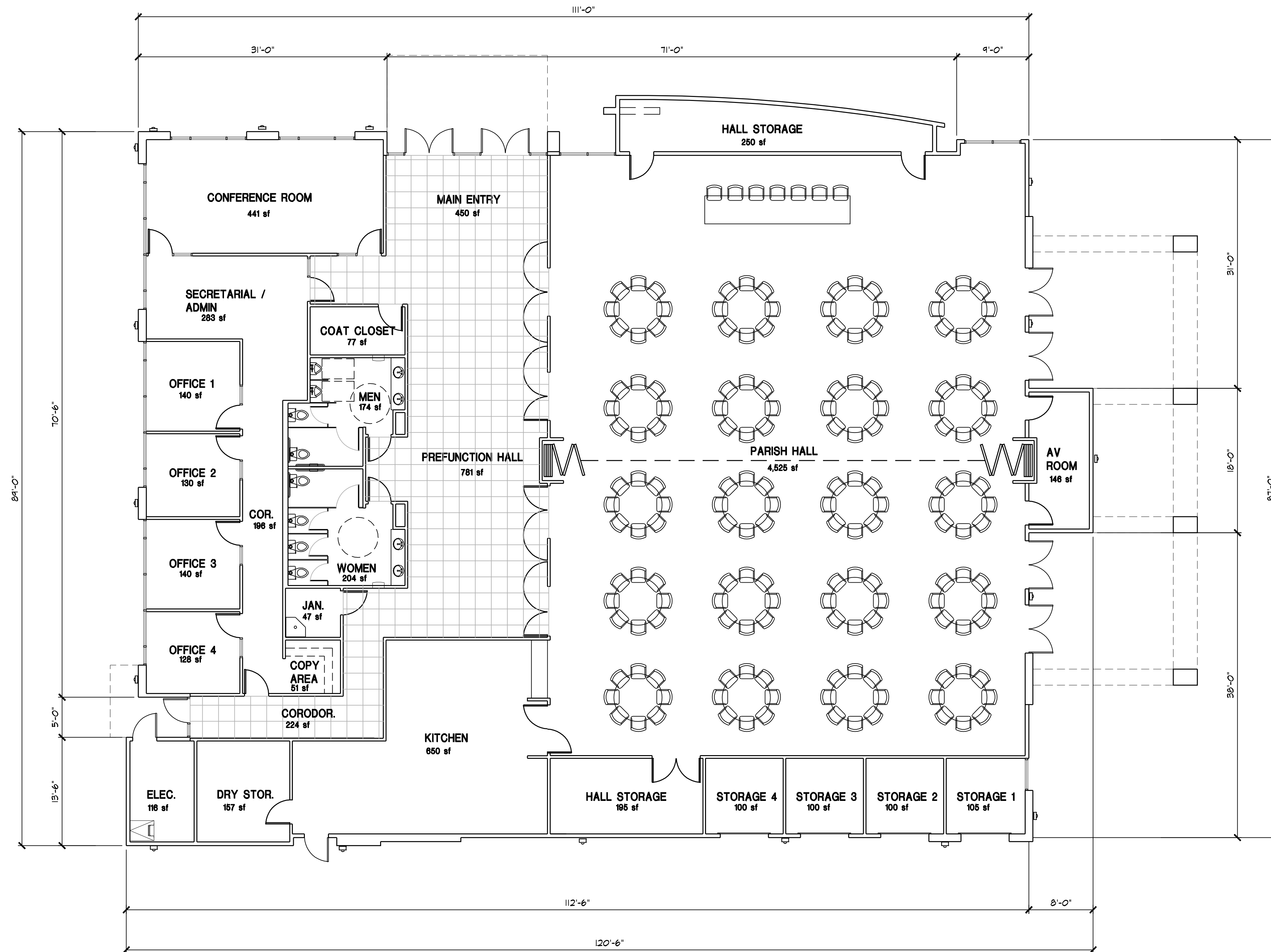

## PRELIMINARY FLOOR PLAN

Client: St. Mels Catholic Church

DATE: JULY 1, 2009  
JOB NO.: 09034  
DRAWN BY: TB

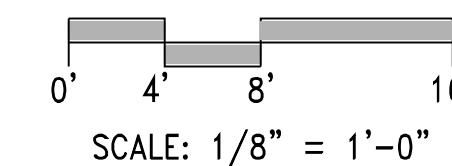

SA-1.10